

Water Shut-Off Valves for Le Parc

Bldg.	Units #	Shut Offs	Bldg.	Units #	Shut Offs
1	25671 #1-12	#1 Common Area #3 Patio #6 Patio	15	25712 #73-84	#73 Patio #75 Patio #78 Common Area
2	25671 #13-24	#19 Patio #21 Patio #23 Patio	16	25712 #85-96	#91 Patio #93 Patio #95 Patio
3	25671 #25-36	#25 Common Area #27 Patio #30 Common Area	17	25761 #1-12	#1 Patio #3 Patio #6 Patio
4	25671 #37-48	#37 Patio #39 Common Area #41 Patio	18	25761 #13-24	#19 Patio #21 Patio #23 Patio
5	25671 #49-60	#55 Patio #57 Common Area #59 Patio	19	25761 #25-36	#25 Patio #27 Patio #30 Patio
6	25671 #61-72	#67 Common Area #69 Patio #72 Common Area	20	25761 #37-48	#37 Patio #39 Patio #42 Common Area
7	25671 #73-84	#75 Patio #78 Patio #84 Patio	21	25761 #49-60	#49 Patio #51 Patio #54 Patio
8	25671 #85-96	#85 Common Area #87 Patio #90 Common Area	22	25761 #61-72	#67 Patio #69 Patio #71 Common Area
9	25712 #1-12	#7 Patio #9 Common Area #11 Common Area	23	25761 #73-84	#73 Patio #75 Patio #78 Patio
10	25712 #13-24	#13 Patio #15 Patio #18 Common Area	24	25761 #85-96	#91 Patio #93 Patio #95 Common Area
11	25712 #25-36	#31 Common Area #33 Patio #35 Patio	25	25761 #97-108	#97 Patio #99 Patio #102 Patio
12	25712 #37-48	#43 Patio #45 Patio #47 Patio	Per the Rules and Regulations for the Le Parc Homeowners Association, 2.10.1, temporary shut down of water. Notice of any disruption of water service shall be provided in advance to all owners affected, and water shall be discontinued at a time convenient to all the owners being affected, except that in the case of an emergency such right of entry shall be immediate. Source CC&R's Section 2.31, 2.32, 2.33, 2.34		
13	25712 #49-60	#49 Patio #51 Patio #54 Patio			
14	25712 #61-72	#61 Patio #63 Patio #66 Common Area			

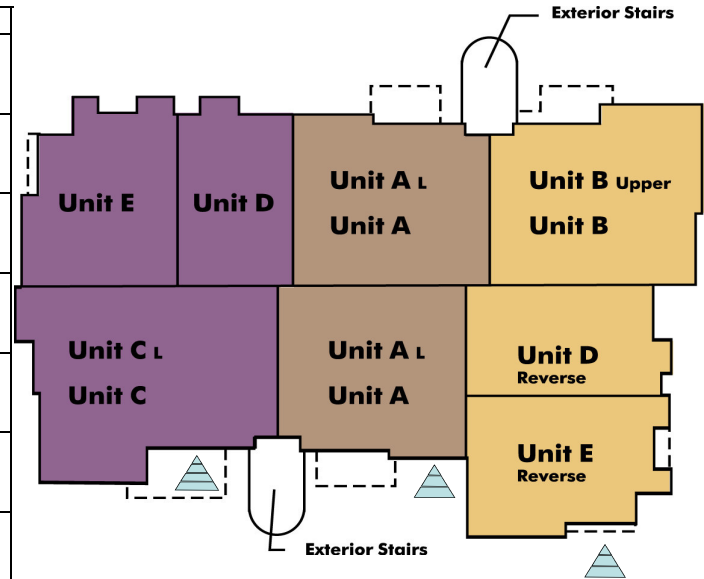

Typical Water shutoff valve locations in relationship to all buildings